

SPRAY CHARACTERISTICS

- Uniform distribution with finest possible atomisation using direct liquid pressure alone.
- The standard spray angles of 40°, 60° or 80° are the nominal angles close to the nozzle orifice.
- For small capacity tips up to say 8 litres/hour the angle falls off rapidly a few inches from the tip. The larger the tip size the further the nominal angle projects before the spray begins to fall away.
- The nozzles produce a hollow cone spray but with the small capacity tips the spray rapidly merges into a "Solid" cone type.

CONSTRUCTION AND MATERIALS

- Nozzle tips precision machined to ensure most perfect spray available at low throughputs.
- Internal distributor, screw pin and strainers are renewable in most sizes.
- Available in Brass and 316 Stainless Steel as standard.
- Nozzle thread is 9/16" - 24 UNEF.
- Adaptors are available with 1/4" Male BSPT and 1/8"/1/4" Female BSPP and can be ordered separately.
- Other materials available to special order.

ORDER EXAMPLE

WA 1408 Stainless Steel = Tip Only.

1/4" Male WA 808 Brass = Complete Assembly.

DIMENSIONS AND WEIGHTS

Assembly Type	Dimensions (mm)					Weight (g)
	A Hex	B	C	D	E Hex	
1/8 Female	15,9	52,4	38,1	14,3	18,0	82
1/4 Male	15,9	52,4	38,1	14,3	18,0	78
1/4 Female	15,9	52,4	38,1	14,3	18,0	69

Maximum Recommended Pressure: 35 Bar.G.

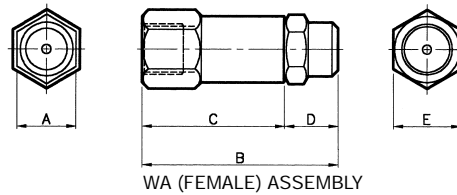
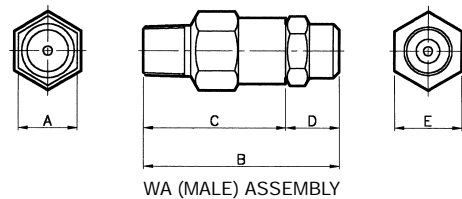

CAPACITY CHART

NOZZLE NUMBERS			MAX MESH SIZE	FLOW RATE IN LITRES/HOUR AT Bar.G.							
SPRAY ANGLES AT 7 Bar.G.				1,5	2	3	3,5	4	6	7	8
40°	60°	80°									
WA 054	WA 056	WA 058	200	-	-	-	-	1,47	2,04	2,29	2,46
WA 074	WA 076	WA 078	200	-	-	2,22	2,42	2,59	3,12	3,20	3,48
WA 104	WA 106	WA 108	200	-	-	3,08	3,25	3,53	4,36	4,57	5,04
WA 124	WA 126	WA 128	200	-	-	3,74	4,03	4,20	5,21	5,49	5,80
WA 154	WA 156	WA 158	200	-	-	4,97	5,03	5,36	6,39	6,86	7,23
WA 204	WA 206	WA 208	80	4,73	5,36	6,39	6,86	7,37	8,76	9,15	9,37
WA 254	WA 256	WA 258	80	5,92	6,47	7,91	8,32	8,93	10,7	11,4	12,1
WA 304	WA 306	WA 308	80	6,87	8,04	9,47	10,1	10,6	12,8	13,7	14,4
WA 354	WA 356	WA 358	80	8,05	9,15	10,9	11,5	12,3	14,9	16,0	17,0
WA 404	WA 406	WA 408	80	9,00	10,0	12,3	13,1	14,1	17,0	18,3	19,4
WA 454	WA 456	WA 458	80	10,27	11,5	13,7	14,6	15,6	18,9	20,6	21,9
WA 504	WA 506	WA 508	80	10,89	12,7	15,2	16,1	17,4	21,1	22,9	24,5
WA 554	WA 556	WA 558	80	12,31	13,8	16,8	17,8	19,2	23,2	25,2	26,9
WA 604	WA 606	WA 608	80	13,26	15,1	18,0	19,2	21,0	25,6	27,4	29,2
WA 704	WA 706	WA 708	80	15,62	17,9	21,3	22,8	24,6	29,8	32,0	34,4
WA 804	WA 806	WA 808	80	17,52	20,1	26,0	26,5	27,7	34,3	36,6	39,7
WA 1004	WA 1006	WA 1008	80	21,31	24,6	30,1	32,5	34,6	42,6	45,7	49,1
WA 1054	WA 1056	WA 1058	80	22,49	25,4	31,2	33,8	36,4	45,0	48,0	51,3
WA 1154	WA 1156	WA 1158	40	25,1	29,5	35,0	38,0	41,1	49,2	52,6	55,8
WA 1404	WA 1406	WA 1408	40	28,4	33,5	41,2	44,6	47,5	59,7	64,0	67,9
WA 1704	WA 1706	WA 1708	40	33,6	39,7	49,2	52,6	56,2	69,8	77,8	85,3
WA 2004	WA 2006	WA 2008	40	43,6	49,1	59,2	64,0	69,2	85,2	91,5	97,3
WA 2504	WA 2506	WA 2508	40	52,1	60,3	73,4	78,2	84,8	104,2	114,3	122,8
WA 3004	WA 3006	WA 3008	40	66,3	74,1	90,0	94,2	101,3	125,0	137,2	150,4
WA 3504	WA 3506	WA 3508	40	75,8	86,6	104,2	109,8	117,2	144,9	160,1	175,0
WA 4004	WA 4006	WA 4008	40	85,2	99,3	118,4	125,8	133,9	165,7	183,0	200,9



HOLLOW CONE SPRAY

TYPE WA

Contact our Helpline for any special requirements:
Tel: +44 (0) 151 424 6821
Fax: +44 (0) 151 495 1043
e-mail: sales@delavan.co.uk
Web: www.delavan.co.uk

